

THIS DOCUMENT AND THE DATA DISCLOSED HEREIN OR HEREWITH IS NOT TO BE REPRODUCED, USED, OR DISCLOSED IN WHOLE OR IN PART TO ANYONE WITHOUT PERMISSION OF VICOR CORP.

REV.	DESCRIPTION	DATE	APPROVED
1	RELEASED PER E053444	11/15/05	EF
2	REVISED PER E060602	03/16/06	ECF

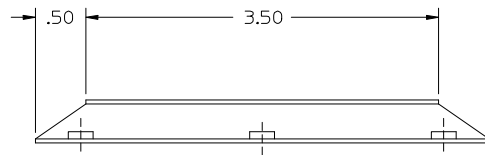
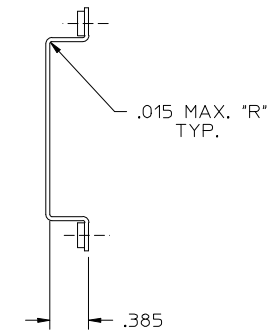
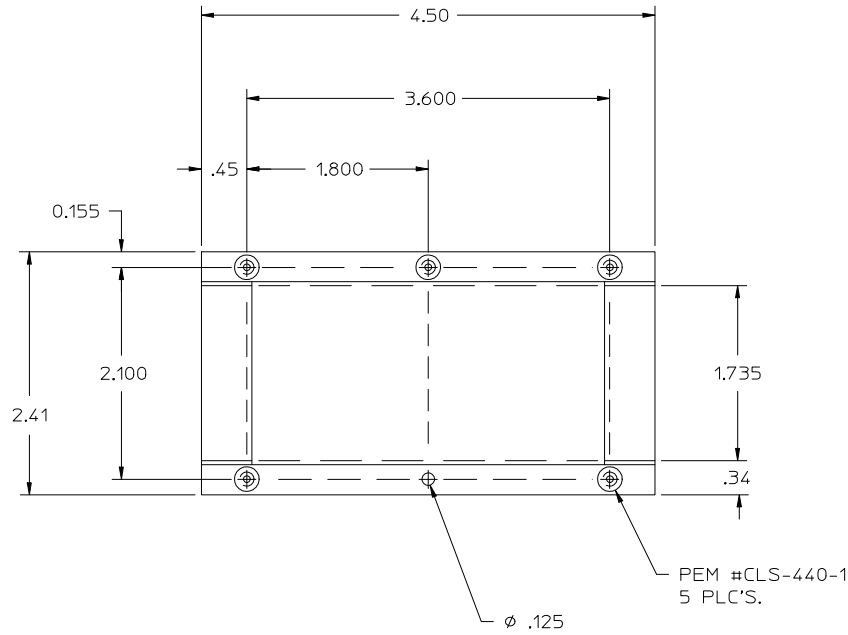

NOTES:

1. MATERIAL: 5052-H32 AL, .040 THICK.
2. REMOVE ALL BURRS AND SHARP EDGES.
3. CLEAR FINISH, ROHS COMPLIANT, CHROMIUM FREE PER CST-0001 LATEST REVISION.
4. ϕ DENOTES CRITICAL CHARACTERISTIC FOR LOT INSPECTION.

DRAWN BY <i>P.E.IENI</i>		DATE 05/24/05			
<small>UNLESS OTHERWISE SPECIFIED DIMENSIONS ARE IN INCHES - TOLERANCES ARE:</small> <small>FRACTIONS DECIMALS ANGLES</small> <small>+1/64 .XX+ .01 +1°</small> <small>.XXX+ .005</small>					
THIRD ANGLE PROJECTION		SIZE C	FSCM NO. 67131	DWG NO. 30139	REV 2
DO NOT SCALE DRAWING		SCALE 1:1	SHEET 1 OF 1		